

| | |
|---------|-------|
| Radlast | 75 kN |
| Charge | 75 kN |
| Portata | 75 kN |

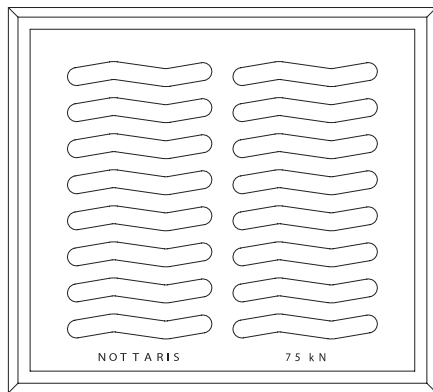

Mit dämpfender Einlage
 Avec garniture amortissante
 Con guarnizione ammortizzante

| Nr. | R1 × R2 | L1 × L2 | D1 × D2 | H | kg |
|-----|-----------|-----------|-----------|----|----|
| 1 | 540 × 500 | 465 × 415 | 495 × 450 | 60 | 57 |
| 2 | 530 × 435 | 455 × 360 | 495 × 400 | 55 | 47 |

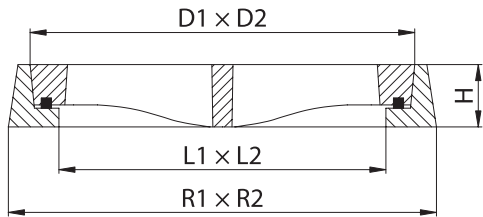